

Smart Diffusion Flammable Gas Detector

GTD-2000Ex

Feature

- ▷ Continuous detection of flammable gases in explosion hazardous area with flame proof structure
- ▷ Self diagnosis function with built-in Microprocessor
- ▷ Detection gas from low to high concentration owing to various detection principle
- ▷ Stable quality and proved detection principle for service life
- ▷ Built-in back light LCD or OLED display
- ▷ Easy Configuration of monitoring by HART communication
- ▷ Auto calibration and program setting with a magnet bar
- ▷ 4-20mA DC output signal
- ▷ With the alarm unit
 - Normal : Green LED
 - Alarm : Red LED, Buzzer(95 dB)
 - Trouble : Yellow LED
- ▷ Calibration and maintenance by one-man

Special Application



Remote type



Insert type



Alarm Beacon Type
(Alarm device)



SIL2

IEC 61508
Safety Integrity Level

HART
COMMUNICATION PROTOCOL



General

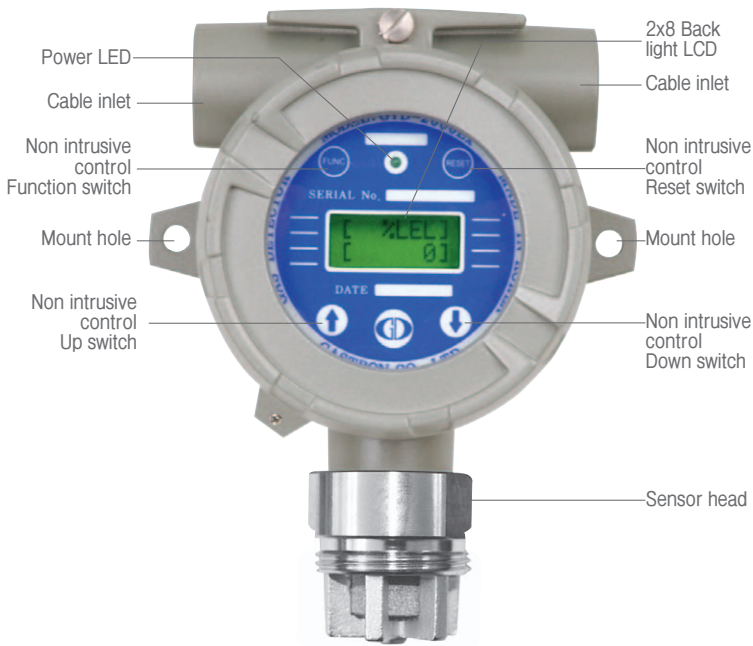

Dimension (Unit:mm)

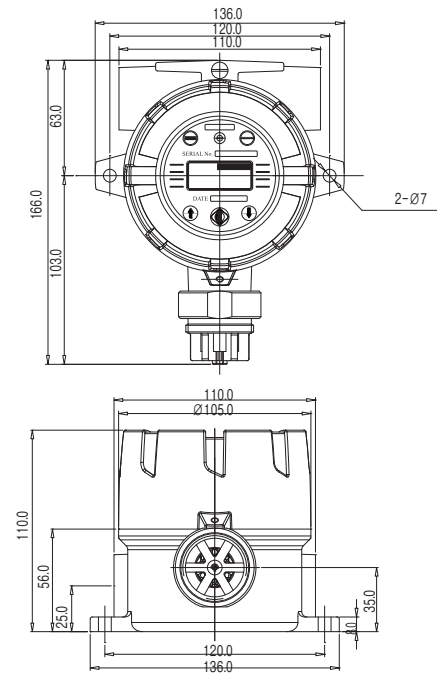

Accessories



Specification

※Specifications are subject to be changed without prior notice.

SMART DIFFUSION FLAMMABLE GAS DETECTOR	
Model	GTD-2000Ex
Measuring gas	Flammable gases (LNG, LPG, H ₂ , Methane, Butane & etc)
Measuring type	Diffusion type
Measuring method	Catalytic cell Hot wire semiconductor cell Thermal conductivity cell
Measuring range	0~100% LEL 0~2000ppm 0~100% Vol
Response time	< 15 sec / 90% scale
Accuracy	±3% / Full scale
Parameter control	Non intrusive control with a Magnet bar (calibration, maintenance)
Operation mode display	1-LED (Power)
Measuring value display	LCD display (Built in back light 2-Line, 8 characters) / OLED Type (Option)
Output signal	Analog : Measuring signal : 4~20mA DC Maintenance signal : 3mA DC Calibration signal : 3mA DC Fault signal : 0mA DC Digital : 2mA (HART 7, HART Device Description Language available, Option)
Cable/Distance	Power + Signal cable : 3-wire > 1.5sq (AWG16) / 2500m max
Material	Housing : ALDC, SUS316(Optional) / Sensor : SUS316
Conduit connection	G. Rc. NPT 1/2", 3/4" & M20 (G 3/4" : standard)
Mounting type	2" Pole mount, Wall mount, Duct mount
Operating temperature	-20°C ~ +60°C / -40°C ~ +80°C (Option)
Operating humidity	5 ~ 99%RH (non-condensing)
Operating power	18-31VDC(24VDCnormal)/200mAmax
Dimensions	136x166x110 (WxHxD)mm
Weight	1.5kg
Approval	Explosion proof type (Ex d IIC T5) KCs / IP66/67 Explosion proof type (Ex d IIC Gb T4~T6) ATEX, IECEx Explosion proof type (Ex d IIC T5 Gb) NEPSI Marine : KR, MED, ABS, DNV KFI, CE, HART, SIL 2