

# GTL – 200 Series

## Combined explosion-proof Alarm Sounder & Beacon

### Product features

- ▷ Combined Explosion- proof Sounder & Beacon using LED Light sources
- ▷ Excellence of high effect of signal light radiation using our unique lens type luminescence system
- ▷ Available of sound types & volume control with internal switch
- ▷ Available in controlling the rotation speed of reflector
- ▷ Available in various colors(Red, Yellow, Green, Blue)
- ▷ Max Output : 120 dB
- ▷ Available in setting options depend on field condition



### External view drawing

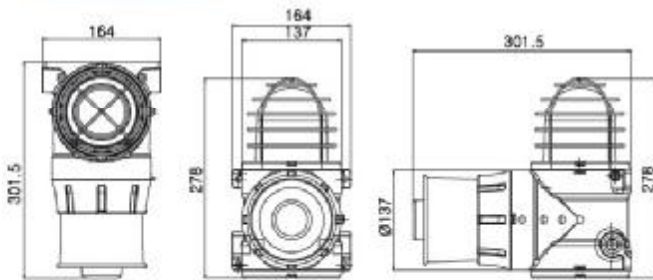

### Specification

| ITEM                  | GTL-200 SERIES SPECIFICATION   |
|-----------------------|--|
| Product Type          | LED Lens / Rotating Reflection   |
| Material              | Body : ALDC12, Reflector : heat-resistant ABS<br>Lamp Lens : heat-resistant PC,<br>GLASS : Explosion-proof Tempered glass,<br>Protection case - SS316L |
| Sounder out put       | MAX 120 dB   |
| LED Color             | Green, Red, Yellow, Blue (Choose 1)  |
| Power Supply          | AC110 / 220V 50-60Hz<br>DC12-48V   |
| Power Consumption     | AC110V=0.323A / 220V=0.163A MAX<br>DC12V=3.0A / DC24V=1.5A / DC48V=0.75A MAX   |
| Operation Temperature | T6=-40 to 60℃ / T5, T4 =-40 to 70℃   |
| Operation Humidity    | 0 to 95% RH (Non-condensing)   |
| Conduct Connection    | 1/2" or 3/4" PF, NPT(3/4" PF standard feature)   |
| Dimensions            | 164(W) X 278.5(H) X 301.5(177)(D) mm   |
| Weight                | App. 6.2kg   |
| Approval              | Ex d II C T4, T5, T6 (IP66)  |

### Selection Guide

- ▷ Available in Volume control
- ▷ Available in rotating speed control
- ▷ Available in a choice of melody with an internal switch  
- Total 5 melodies file

#### ※ Operation Dip-Switch on/off of Main PCB

| 1   | 2   | 3   | 4   | Sound Type |
|-----|-----|-----|-----|------------|
| on  | off | off | off | Sound 1    |
| off | on  | off | off | Sound 2    |
| on  | on  | off | off | Sound 3    |
| off | off | on  | off | Sound 4    |
| off | off | off | on  | Sound 5    |

### Terminal Connection

| NO. | PCB Silk | Pin Name | Description             |
|-----|----------|----------|-------------------------|
| 1   | L1       | AC_L     | AC Power(Live) / DC+    |
| 2   | L2       | AC_N     | AC Power(Natural) / DC- |
| 3   | S1       | Sound_1  | External Contact_1      |
| 4   | S2       | Sound_2  | External Contact_2      |
| 5   | COM      | GND      | Digital GROUND          |

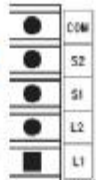

### GTL-200B/ Explosion-Proof Sounder

#### Specification



| ITEM                  | SERIES SPECIFICATION  |
|-----------------------|---|
| Product Type          | Signal Phone  |
| Material              | Body - ALDC12, Flame Arrester - SS316L  |
| Max                   | MAX 120 dB  |
| Power Supply          | AC110 / 220V 50~60Hz<br>DC 12~48V   |
| Power Consumption     | AC110V = 0.174A / 220V = 0.087A MAX<br>DC12V = 1.6A / DC24V = 0.8A / DC48V = 0.4A MAX |
| Operation Temperature | T6=- 40 to 60℃ / T5, T4 = - 40 to 70℃   |
| Operation Humidity    | 0 to 95% RH (Non- Condensing)   |
| Conduct Connection    | 1/2" or 3/4" PF, NPT(3/4" PF standard feature)  |
| Dimensions            | 164(W) X 139(H) X 301.5(177)(D) mm  |
| Weight                | App. 5.0kg  |
| Approval              | Ex d II C T4, T5, T6 (IP66)   |

### GTL-200L/ Explosion-Proof Warning Light

#### Specification



| ITEM                  | SERIES SPECIFICATION   |
|-----------------------|--|
| Product Type          | LED Lens / Rotating Reflection   |
| Material              | Body : ALDC12, Reflector : heatresistant ABS<br>Lamp Lens : heat-resistant PC, GLASS : Explosion-proof<br>Tempered glass, Protection case - SS316L |
| LED Color             | Green, Red, Yellow, Blue (Choose 1)  |
| Power Supply          | AC110 / 220V 50~60Hz<br>DC 12~48V  |
| Power Consumption     | AC110V = 0.109A / 220V = 0.054A MAX<br>DC12V = 1.0A / DC24V = 0.5A / DC48V = 0.25A MAX   |
| Operation Temperature | T6=- 40 to 60℃ / T5, T4 = - 40 to 70℃  |
| Operation Humidity    | 0 to 95% RH (Non- Condensing)  |
| Conduct Connection    | 1/2" or 3/4" PF, NPT(3/4" PF standard feature)   |
| Dimensions            | 164(W) X 278.5(H) X 177(D) mm  |
| Weight                | App. 5.0kg   |
| Approval              | Ex d II C T4, T5, T6 (IP66)  |



### GTL-200BL/ Explosion-Proof Combination

| Composition type | Structural elements   |
|------------------|---|
| EX) TYPE - 1     | Warning Light(RED) + Sounder  |
| EX) TYPE - 2     | Warning Light(RED) + Warning Light(BLUE)                                      |
| EX) TYPE - 3     | Warning Light(RED) + Warning Light(YELLOW) + Warning Light(BLUE)              |
| EX) TYPE - 4     | Warning Light(RED) + Warning Light(YELLOW) +<br>Warning Light(BLUE) + Sounder |